

RECEIVED
3/10/2018
TOOWOOMBA
REGIONAL COUNCIL

STAGE	LOTS	TOTALS
1	1-22, 78-83, 94-96, 108-115	39
2	23-36, 37, 44-51, 57-107	36
3	37-76	40
		115

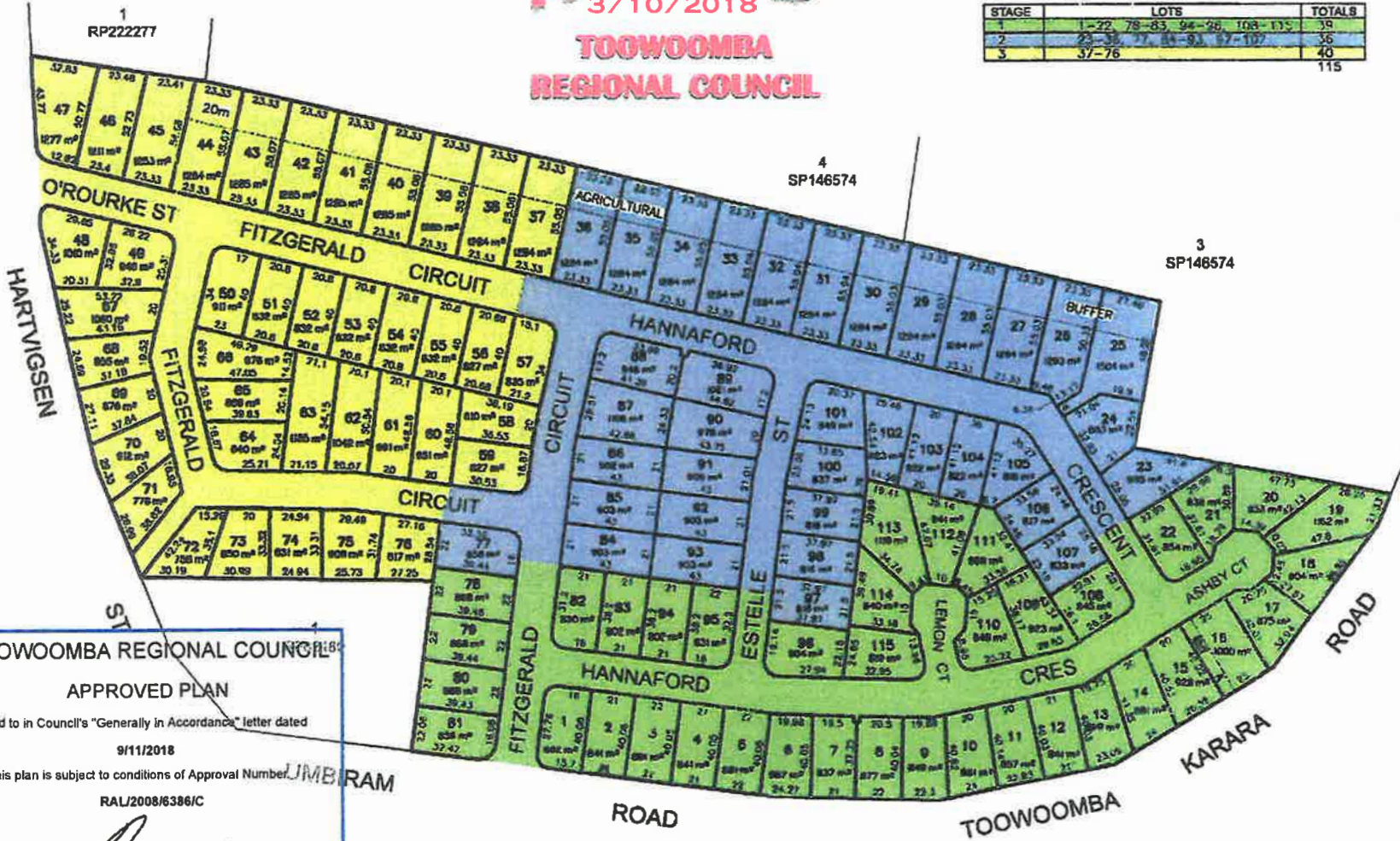

TOOWOOMBA REGIONAL COUNCIL
APPROVED PLAN
referred to in Council's "Generally in Accordance" letter dated
9/11/2018
This plan is subject to conditions of Approval Number **JMB/2008/6386/C**

Assessment Manager



 PARKINSON SURVEYS Consulting Cadastral & Engineering Surveyors 183 Herries St, Toowoomba, QLD, 4350 Ph. 07 46323244 Email: mail@parkinsonsurveys.com.au	This plan was prepared for the purpose and exclusive use of the client to accompany an application to the Toowoomba Regional Council for approval to reconfigure the land described in the plan and is not to be used for any other purpose or by any other person or corporation. Parkinson Surveys Pty Ltd accepts no responsibility for any loss or damage suffered, however arising, to any person or corporation who may use or rely on this plan in contravention of the terms of this clause. The dimensions, area, size of lots shown on this plan are approximate only and may vary. This plan may not be reproduced unless this note is included.	Client PIXIE INVESTMENTS PTY LTD	RPD LOT 12 ON RP920338	Address 700 TOOWOOMBA KARARA RD	PROPOSED RECONFIGURATION (1 INTO 115)		
		Scale 1 : 2000 @ A3	Surveyed N/A	Drawn SCM			
		Date N/A	Date 3/10/18	Local Authority TOOWOOMBA RC	Surveyor Ref. 12581	Drawing No. 12581 PROPOSAL	Revision D

STAGE	LOTS	TOTALS
1	22, 76-83, 94-96, 108-115	39
2	23-36, 77, 84-93, 97-107	35
3	37-75	40
		115

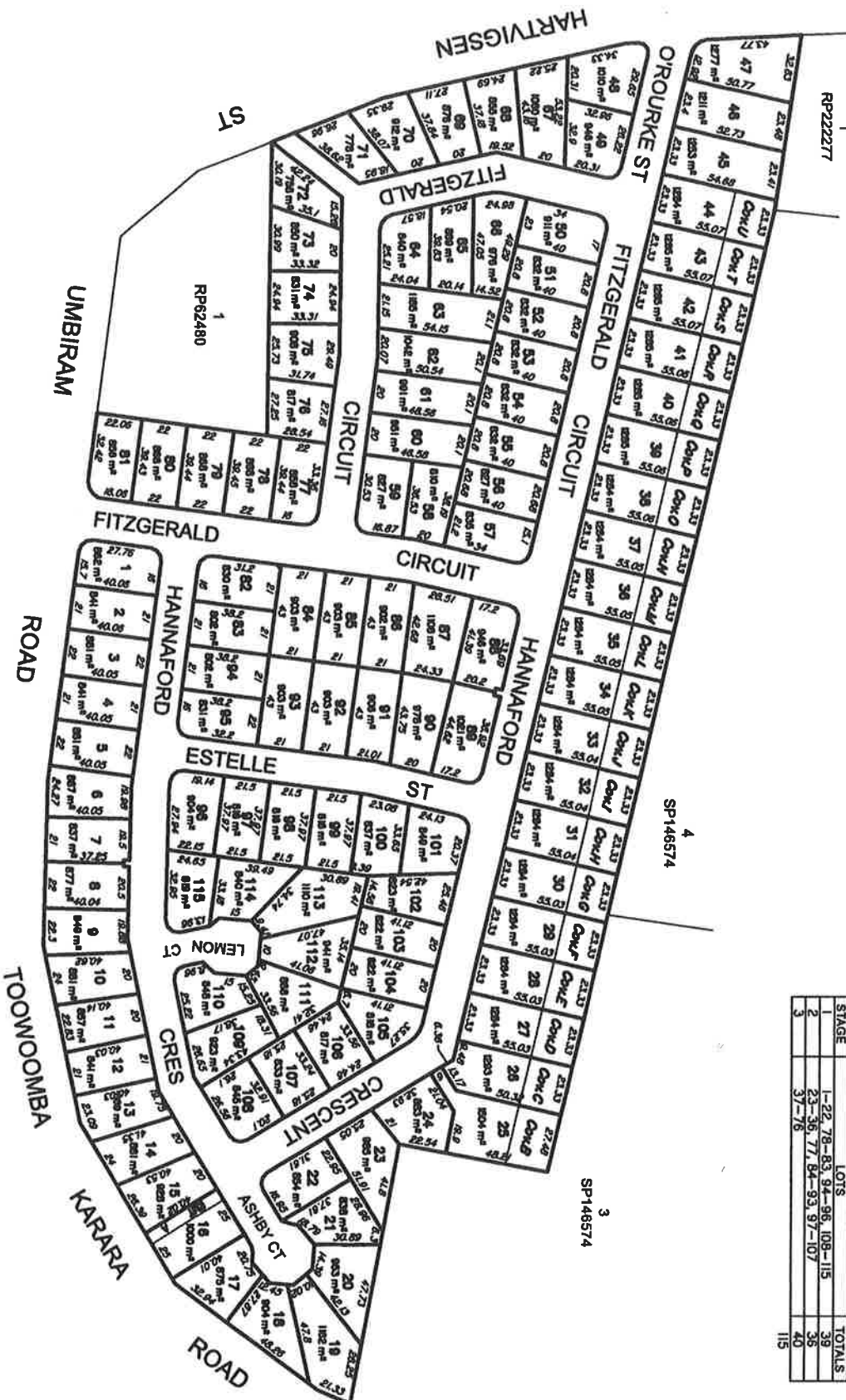

PARKINSON
CONSULTING CADASTRAL & ENGINEERING SURVEYORS
 183 Herries St, Toowoomba, QLD, 4350
 Ph. 07 46121244
 Email: mail@parkinsonsurveyors.com.au

This plan was prepared for the purpose and exclusive use of the client to accompany an application to the Toowoomba Regional Council for approval to reconfigure the land described in the plan and is not to be used for any other purpose or by any other person or corporation. Parkinson Surveyors Pty Ltd accepts no responsibility for any loss or damage suffered, howsoever arising, to any person or corporation who may use or rely on this plan in connection with any application to Council. The dimensions, area, size of lots shown on this plan are approximate only and may vary. This plan may not be reproduced unless this note is included.

Client	Scale	RPD	Address	Title
PIVET INVESTMENTS PTY LTD	1 : 2000 @ A3	LOT 12 ON RP902398	700 TOOWOOMBA KARARA RD	PROPOSED RECONFIGURATION (1 INTO 115)
Surveyed	N/A	Drawn	Locality	Surveyor Ref.
Date	N/A	30/08/2019	WYREEMA	12881
			Local Authority	Drawing No.
			TOOWOOMBA RC	12881 PROPOSAL
				Revision
				E