

LEGEND:

- Proposed Property Boundary
- Existing Property Boundary
- Existing Easement Boundary
- - - - - Proposed Stage Boundary
- █ Proposed/future footpath
- █ Dual use footpath/shared driveway
- > Probable Future Local Access Road
- █ Stage 1 Lots
- █ Stage 2 Lots
- █ Stage 3 Lots
- █ Stage 4 Lots
- █ Stage 5 Lots

NOTE:
Footpaths shown are indicative only. As the development proceeds through the various stages, amendments to the footpath alignments may be required due to latent constraints and conditions.

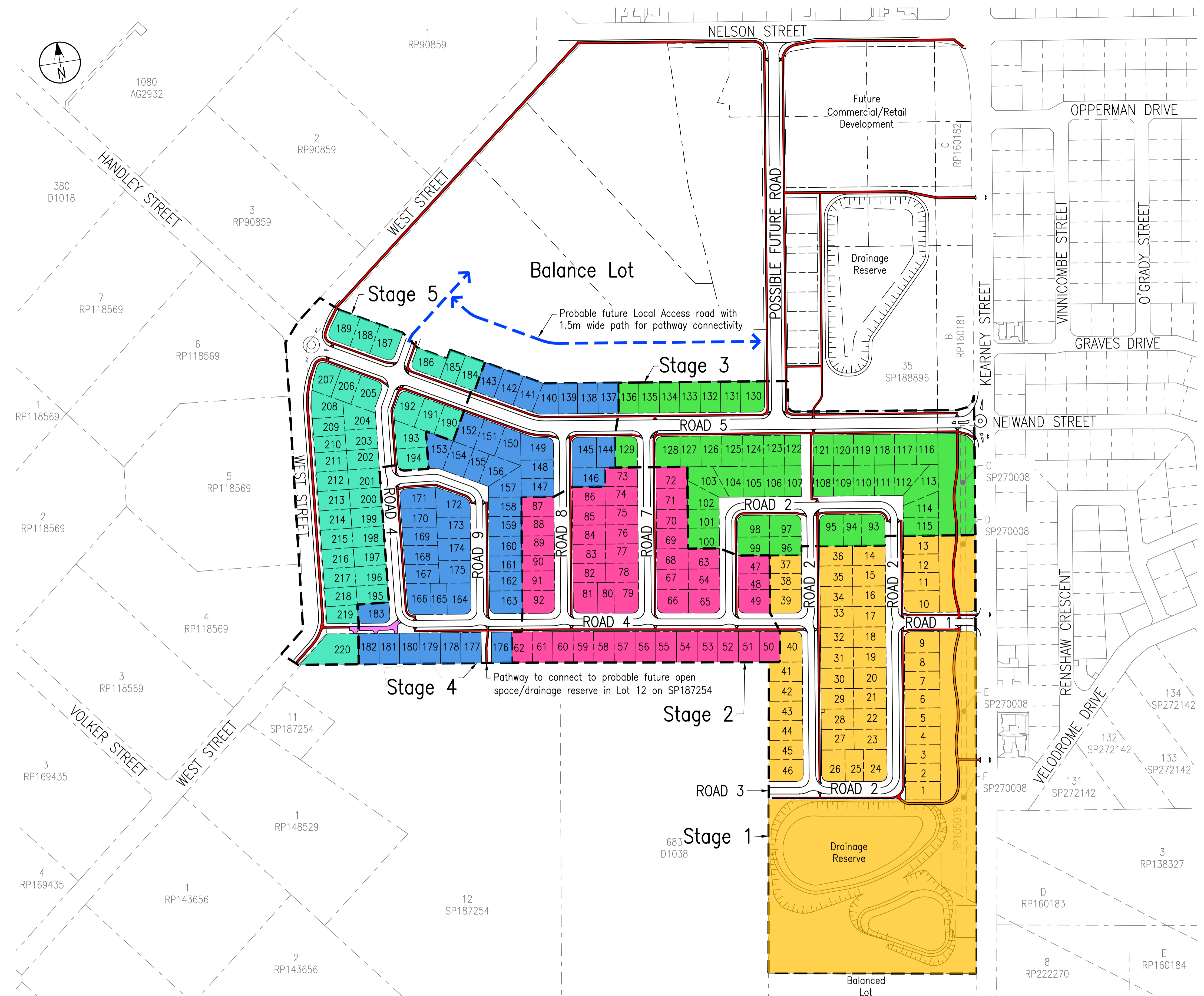

PRELIMINARY
17 April 2020

KEARNEY WEST LOCALITY PLAN

Scale 1:2000 (A1)

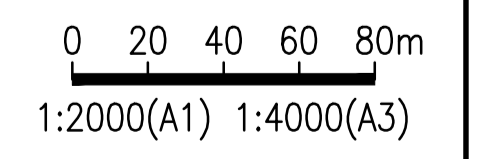

ISSUE	DESCRIPTION	DATE	BY	CHK	APP
A	FOR INFORMATION	17/04/20	KNO	KNO	
			DWN	DES	

NOTE: FIGURED DIMENSIONS TO TAKE PRECEDENCE OVER SCALED MEASUREMENTS. VERIFY ALL ON SITE DIMENSIONS & LEVELS PRIOR TO THE COMMENCEMENT OF ANY CONSTRUCTION. CONTRACTOR TO NOTIFY ENGINEER IMMEDIATELY OF ANY DISCREPANCIES. COPYRIGHT OF THIS DRAWING IS VESTED WITH RMA ENGINEERS PTY. LTD.



CLIENT
JETELD PTY LTD
PO BOX 9109
WILSONTON QLD 4350

PROJECT
SUBDIVISION KEARNEY STREET TOWOOMBA QLD 4350

TITLE
KEARNEY WEST LOCALITY PLAN

R.P.E.Q.
THIS DOCUMENT IS UNCONTROLLED AND IS NOT TO BE USED FOR CONSTRUCTION UNTIL THIS NOTE IS REMOVED AND A DIGITAL SIGNATURE PROVIDED IN ITS PLACE

PROJECT NO.
12985

COUNCIL RAL/MCU NO.
RAL/2017/2512

COUNCIL OW NO.
OW/2018/4644

DRAWING NO. ISSUE
C-SK0015 A